

...right place for
complete family



Plot No. 16, Old Sneh Nagar, Warsha Road, Nagpur.



**SWAPNIL
KADAMB**

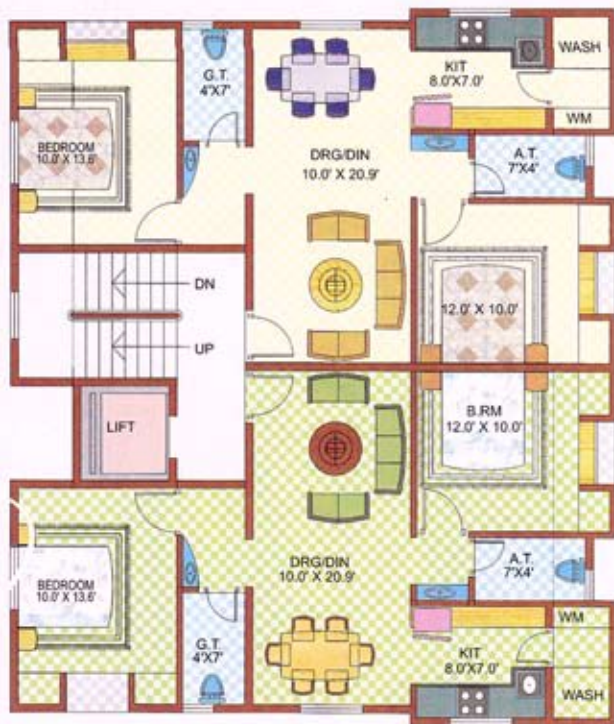

TYPICAL FIRST TO FOURTH FLOOR PLAN
TOTAL SALABLE AREA 925 SQ. FT.





Swapnil Kadamb



Construction Specifications for Swapnil- Kadamb

Frame Structure	: R.C.C. Frame Structure for Entire Building.
Walls	: External walls of 0.15 M thick B.B. Masonary & internal walls for & 0.115 M thick B.B. Masonary.
Plaster	: Internal plaster Shall be Farty plaster and External plaster shall be sand faced plaster.
Flooring	: All flooring shall be laid and polished Ceramic/Vettrified Tiles.
Toilets	: All Toilets shall be provided with full height Ceramic ties, closet, comode, with cistem, mixing cocks where ever possible.
Doors	: All doors are flush door.
Windows	: All Windows in Aluminum sliding with M.S. grills.
Kitchen	: Raised Cooking platform in granite of approved shade, with dado of ceramic tiles and stainless Steel sink.
Electrical	: Concealed wiring to achieve required illumination level with ISI standard make switches.
Painting	: Internal painting in Acrylic paint External Waterproof paint.
Staircase	: All trades shall be fitted with Kota stone & riser shall be IPS.
Water Connection	: There shall be common water meter connection. There shall be U.G.R. and E.W.R. of suitable capacity with pump installed on it.
Lift	: The Building shall be installed with a mechanised lift of Johnson make with auto doors and shall have generator/inverter back up.
Parking	: The apartments shall have covered parking under stilt.

Special Features :

1. Inverter back up for common lighting including lift and pump.
2. Stand by pump for underground sump.
3. Automatic water level controller for overhead tanks.
4. All the apartments shall have inverter circuit.



363, M.A.K. Azad Road, Gandhi Nagar, Nagpur - 10
Ph. : 0712-2248221, 2248223 Fax - 0712-2248583

Email : swapnilsahara58@rediffmail.com, swapnilsahara@swapnilgroup.com
Visit us at : www.swapnilgroup.com

A Project By SAHARA DEVELOPERS & Promoters Pvt. Ltd.

Architect
S. D. Shome, Nagpur

Structural Eng.
P. P. Deshpande, Nagpur

Legal Adviser
Mr. Uthas Aarungbadkar, Nagpur

Financial Adviser
Mr. Nitin Bokare, nagpur